



# WELCOME TO BINGHAM HIGH SCHOOL

School website: [binghamminers.org](http://binghamminers.org)

Counseling website: [binghamcounseling.org](http://binghamcounseling.org)

## THE OFFICES

### MAIN OFFICE 801-256-5100

- Pay school fees
- Pay for lunch
- Parking passes

### ATTENDANCE OFFICE 801-256-5110

- Check in / Check out
- Bus pass

### REGISTRAR OFFICE 801-256-5208

- Help ordering transcripts

### COUNSELING OFFICE 801-256-5120

- Academic, emotional, social, mental health support
- Schedules, scholarships, and planning for post high

### McKinney Vento 801-256-5607

- Help with clothing, food, and other needs

## SUPPORT

### COUNSELORS 801-256-5120

- Sara Blaney (A-Can)
- Libby Spicker (Cao-Fh)
- Mackenzie Coburn (Fi-H)
- Tina Mitchell (I-Mar)
- Megan Larson (Mas-Pe)
- Steven Broadhead (Pf-St)
- Emily Williams (Su-Z)

### SCHOLARSHIP SPECIALIST

- Tonya Bronson 801-256-5158

### WELLNESS CENTER

- 801-256-5168

### ADMINISTRATION 801-256-5100

- Rodney Shaw - Principal
- Sally Wilde (A-C)
- Ivie Erickson (D-G)
- Art Erickson (H-L)
- Rufine Einzinger (M-R)
- Vaega Toilolo (S-Z)

### SPECIAL ED 801-256-5132

- Jake Williams

### MENTAL HEALTH SPECIALIST

- Brian Fait 801-256-5162

### SCHOOL PSYCHOLOGIST

- Clinton Thurgood 801-256-5121

# IT'S A GREAT DAY TO BE A MINER!

## SKYWARD

- Provided on Registration forms received by the Attendance Office

## LOGIN INFO

## COMPUTER

- Login: Same as Skyward login  
Password: Student number + jordan  
(Example: 1234567jordan)

## CANVAS

- Login & Password: JSD Google Account
- Click on Google Apps Icon (the waffle)
- Scroll down to Canvas Login

## GET INVOLVED

### • CLUB RUSH WEEK (SEPTEMBER)

- LATINOS IN ACTION
- PEOPLE OF THE PACIFIC
- HOPE SQUAD
- NATIONAL HONOR SOCIETY
- GOLDEN GATE CLUB
- ATHLETICS
- PERFORMING ARTS
- ACADEMICS
- YEARBOOK
- PEER TUTORING
- SKILLS USA
- DECA / HOSA / FBLA
- AND MUCH MORE!



**\*Message for parents\***

For more information on how you can get involved to support Bingham, reach out to [lisa.ford@jordandistrict.org](mailto:lisa.ford@jordandistrict.org).

# MONDAY - THURSDAY BELL SCHEDULE



## BINGHAM HIGH SCHOOL

2024-2025 REGULAR BELL SCHEDULE  
MONDAY THROUGH THURSDAY

<b>Warning Bell</b>	7:25a		
<b>1<sup>st</sup> / 5<sup>th</sup> Period</b>	7:30a	9:05a	95 min.
<b>2<sup>nd</sup> / 6<sup>th</sup> Period</b>	9:10a	10:40a	90 min.
<b>A Lunch</b>	10:40a	11:15a	35 min.
<b>3<sup>rd</sup> / 7<sup>th</sup> Period</b>	11:20a	12:50p	90 min.
<b>3<sup>rd</sup> / 7<sup>th</sup> Period</b>	10:45a	12:15p	90 min.
<b>B Lunch</b>	12:15p	12:50p	35 min.
<b>4<sup>th</sup> / 8<sup>th</sup> Period</b>	12:55p	2:25p	90 min.

\*\*\* Lunch is determined by the 3<sup>rd</sup> or 7<sup>th</sup> Period class.\*\*\*

A Lunch: 2<sup>nd</sup> Floor (Includes Seminary)

B Lunch: 1<sup>st</sup> Floor (Includes FACS, Gym, and Vocational Hall)

# FRIDAY BELL SCHEDULE



## BINGHAM HIGH SCHOOL

### 2024-2025 FRIDAY BELL SCHEDULE

<b>Warning Bell</b>	8:25a		
<b>1<sup>st</sup> / 5<sup>th</sup> Period</b>	8:30a	9:35a	65 min.
<b>2<sup>nd</sup> / 6<sup>th</sup> Period</b>	9:40a	10:40a	60 min.
<b>A Lunch</b>	10:40a	11:10a	30 min.
<b>3<sup>rd</sup> / 7<sup>th</sup> Period</b>	11:15a	12:15p	60 min.
<b>3<sup>rd</sup> / 7<sup>th</sup> Period</b>	10:45a	11:45a	60 min.
<b>B Lunch</b>	11:45a	12:15p	30 min.
<b>4<sup>th</sup> / 8<sup>th</sup> Period</b>	12:20p	1:20p	60 min.
<b>Personalized Learning</b>	1:25p	2:25p	60 min.

\*\*\* Lunch is determined by the 3<sup>rd</sup> or 7<sup>th</sup> Period class.

A Lunch: 2<sup>nd</sup> Floor (Includes Seminary)

B Lunch: 1<sup>st</sup> Floor (Includes FACS, Gym, and Vocational Hall)

# A / B CALENDAR

August 2024						
M	T	W	T	F	S	S
				1	2	
5	6	7	8	9		
12	13	14	15	16		
19	20	21	22	23		
26	27	28	29	30		

20: First Day of School  
23-31: Winter Recess

September 2024						
M	T	W	T	F	S	S
2	3	4	5	6		
9	10	11	12	13		
16	17	18	19	20		
23	24	25	26	27		
30						

4: Labor Day Recess  
27: High/Middle Teacher Compensatory Day

October 2024						
M	T	W	T	F	S	S
		1	2	3	4	
7	8	9	10	11		
14	15	16	17	18		
21	22	23	24	25		
28	29	30	31			

4: Teacher Professional Development Day  
21-25: Fall Recess  
28: Grade Transmittal Day

November 2024						
M	T	W	T	F	S	S
4	5	6	7	8		
11	12	13	14	15		
18	19	20	21	22		
25	26	27	28	29		

5: TENTATIVE Pre-ACCT Test & College Prep 1/2 Day  
10th & 12th Attend, No School for 11th

B: Teacher Professional Development Day  
27-29: Thanksgiving Recess

December 2024						
M	T	W	T	F	S	S
2	3	4	5	6		
9	10	11	12	13		
16	17	18	19	20		
23	24	25	26	27		
30	31					

23-31: Winter Recess

January 2025						
M	T	W	T	F	S	S
6	7	8	9	10		
13	14	15	16	17		
20	21	22	23	24		
27	28	29	30	31		

1-3: Winter Recess  
20: Martin Luther King, Jr. Day Recess  
21: Grade Transmittal Day

February 2025						
M	T	W	T	F	S	S
10	11	12	13	14		
17	18	19	20	21		
24	25	26	27	28		

7: Health & Wellness Virtual Day  
14: High/Middle Teacher Compensatory Day  
17: Washington & Lincoln Day Recess

March 2025						
M	T	W	T	F	S	S
3	4	5	6	7		
10	11	12	13	14		
17	18	19	20	21		
24	25	26	27	28		
31						

11: ACT Test for 11th Grade  
10th & 12th No School, 11th Grade Attends

14: Teacher Professional Development Day  
31: Grade Transmittal Day

April 2025						
M	T	W	T	F	S	S
7	8	9	10	11		
14	15	16	17	18		
21	22	23	24	25		
28	29	30				

1-4: Spring Recess

May 2025						
M	T	W	T	F	S	S
5	6	7	8	9		
12	13	14	15	16		
19	20	21	22	23		
26	27	28	29	30		

26: Memorial Day Recess

June 2025						
M	T	W	T	F	S	S
2	3	4	5	6		
9	10	11	12	13		
16	17	18	19	20		
23	24	25	26	27		
30						

5: High School Graduations  
6: Last Day of School  
9: Emergency Closure Make-Up Day



# BINGHAM HIGH SCHOOL

## 1ST FLOOR

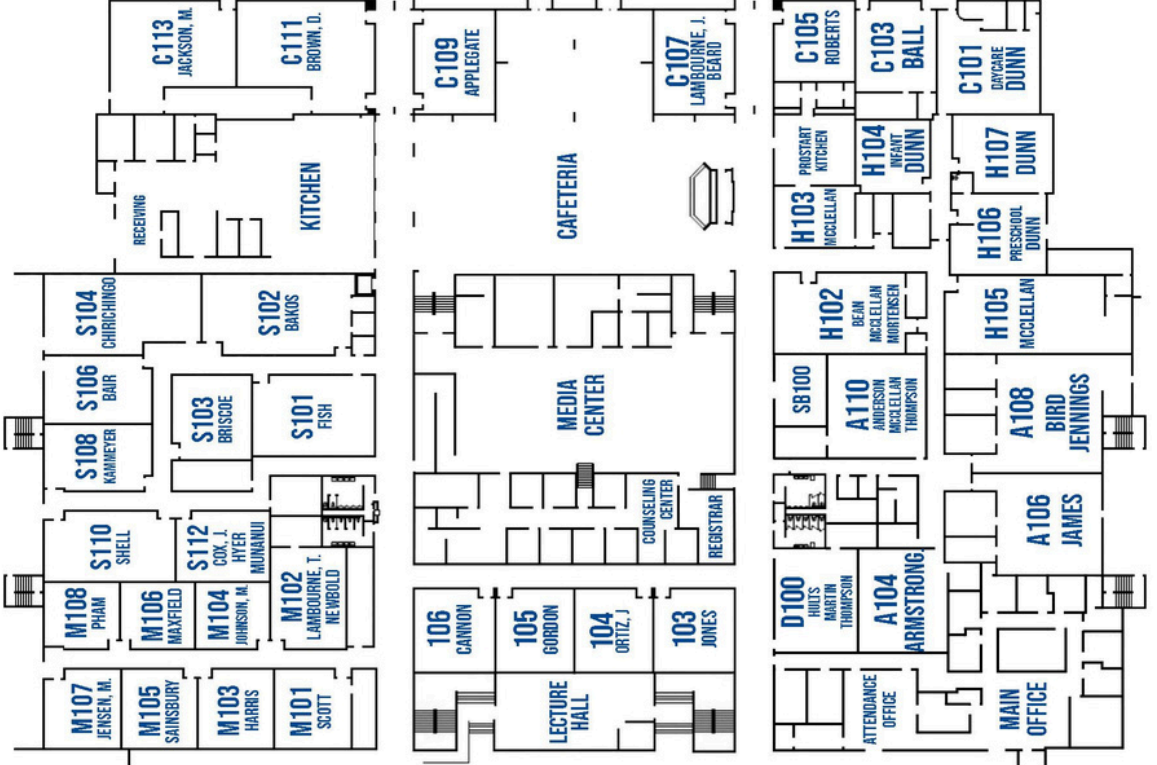
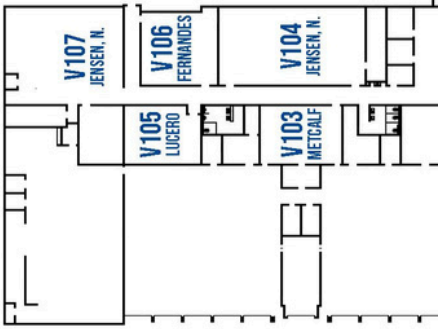





# BINGHAM HIGH SCHOOL

## 2ND FLOOR



# Bingham

## GRADUATION REQUIREMENTS

STUDENTS ARE ELIGIBLE TO GRADUATE FROM  
BINGHAM HIGH SCHOOL AFTER COMPLETING  
**27 CREDITS** IN THE FOLLOWING CORE REQUIREMENTS:

STUDENTS CREATE THEIR OWN SCHEDULE USING ARENA SCHEDULING.  
COUNSELORS HELP GUIDE STUDENTS WITH CLASS SELECTION  
TO MEET GRADUATION REQUIREMENTS.

<b>CTE..... 1.0 credit</b> <b>Financial Literacy..... .50 credit</b>	<b>Fine Arts..... 1.50 credit</b> <b>Digital Studies..... .50 credit</b>
<b>Language Arts..... 4.0 credits</b> Language 9..... 1.0 credit Language 10..... 1.0 credit Language 11..... 1.0 credit Language 12..... 1.0 credit	<b>PE/Healthy Lifestyles.....2.0 credits</b> PST..... .50 credit Fit for Life..... .50 credit Health..... .50 credit PE Elective..... .50 credit
<b>Math..... 3.0 credits</b> Core ..... 1.0 credit Core ..... 1.0 credit Elective .....1.0 credit	<b>Science..... 3.0 credits</b> Core ..... 1.0 credit Core ..... 1.0 credit Elective .....1.0 credit
<b>Social Studies..... 3.5 credits</b> Geography ..... 1.0 credit World History ..... 1.0 credit US History..... 1.0 credit US Gov..... .50 credit	<b>Electives..... 8.0 credits</b>



# Bingham

## CLASS CHANGE POLICY

THERE SHOULD BE VERY FEW SCHEDULE CHANGES SINCE STUDENTS REQUEST THEIR OWN SCHEDULES THROUGH ARENA.

IN FOLLOWING DISTRICT GUIDELINES, AT EACH GRADING PERIOD, CLASS CHANGES WILL NOT BE MADE AFTER THE FIRST 10 DAYS OF SCHOOL

This includes wanting to add or drop:

- Home release
- Work release
- Seminary
- Teachers aide
- Dropping a class if credit is not needed
- Changing lunches
- Classes are boring or unappealing
- Wanting to move to online classes
- A different teacher is preferred
- Getting teacher approval to join a class

THE CLASS CHANGE POLICY WAS CREATED TO:

- Protect curriculum time
  - Minimize distractions and disruptions
  - Award full credit/ grade
  - Prevents students from being academically behind in another course
  - Guide students to make committed choices
- (There are few class options to change into at quarter breaks)*

# DISTRICT RESOURCES



## JORDAN HEALTH & WELLNESS

Mental health resources including a comprehensive list of community providers. District crisis support, suicide, bullying, and violence prevention, student health & wellness and more.

**CONTACT** <https://wellness.jordandistrict.org/>  
**INFO** 801-567-8245

---



## JORDAN FAMILY EDUCATION CENTER (JFEC)

Free classes, short-term counseling, and support groups for students and families. Class topics vary from anxiety, anger, grief, parenting skills, substance abuse, bullying, and more.

**CONTACT** <https://guidance.jordandistrict.org/jfec/>  
**INFO** 801-565-7442

---



## JORDAN LANGUAGE & CULTURE SERVICES

Provides culture and language support to schools, families, and communities including interpreting, English classes family outreach, refugee services, teacher training & support, etc.

**CONTACT** <https://compliance.jordandistrict.org/lcs/>  
**INFO** 801-567-8124

---



## JORDAN SCHOOL COUNSELING

District wide resources for the whole student the promote wellness and access in social-emotional wellness, academic success, future planning, mental health resources, brief intervention counseling and more.

**CONTACT** <https://counseling.jordandistrict.org/>  
**INFO** 801-567-8309

Student Name: \_\_\_\_\_



# PARENT QUESTIONNAIRE

1. What is the best way to communicate with your family (e.g. email or phone)? What time of day is best? Please list specific contact information.

---

---

---

---

---

2. How can we best support your student?

---

---

---

---

---

3. Is there something you would like to tell us about your student?

---

---

---

---

---

4. What is the biggest concern that we should be aware of so that we can best help your student?

---

---

---

---

---